

# CITY TOWER II

12a

13

14

1588.5

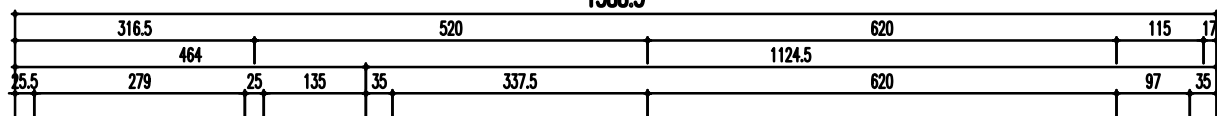

C.1

D.1

F

F

G

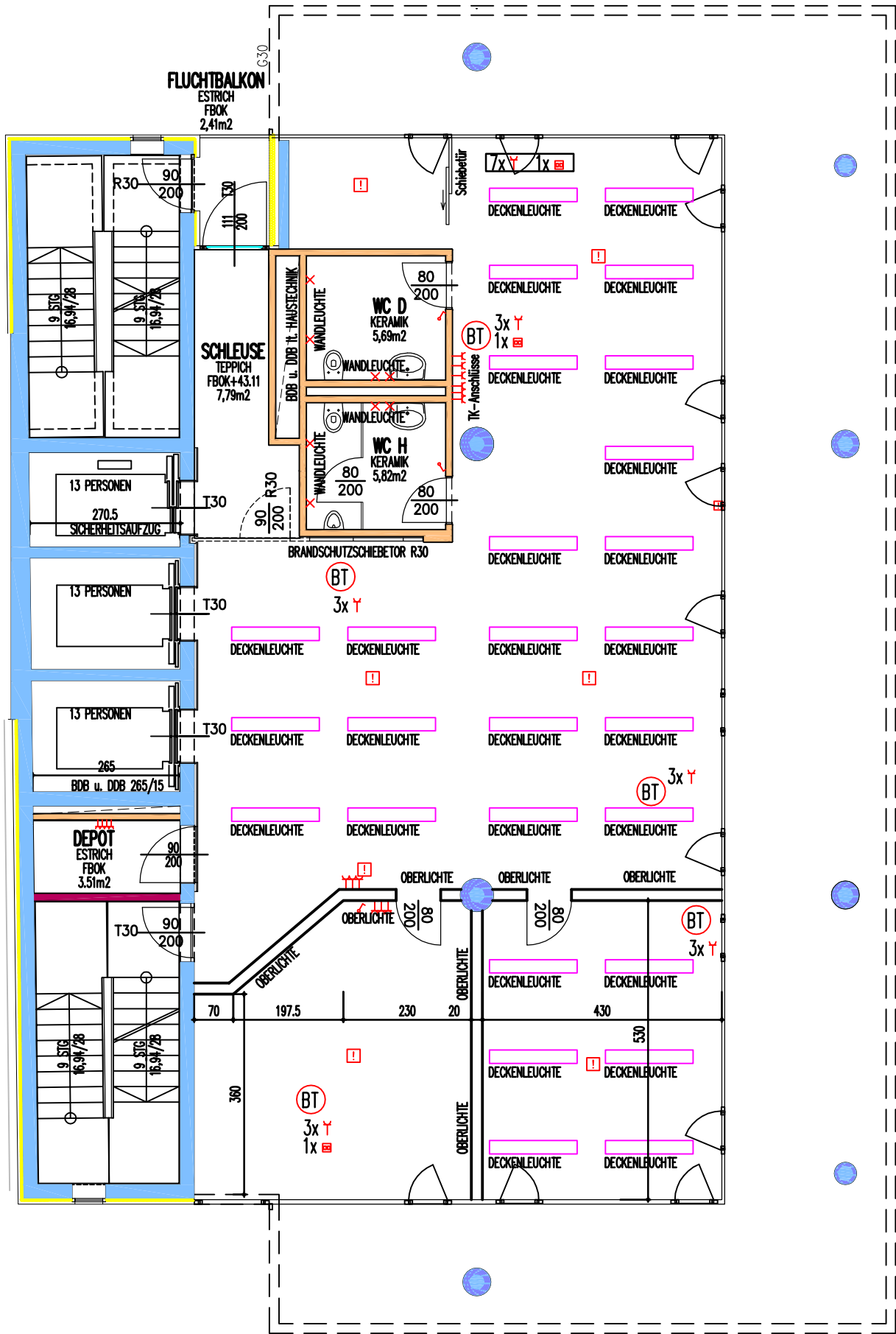
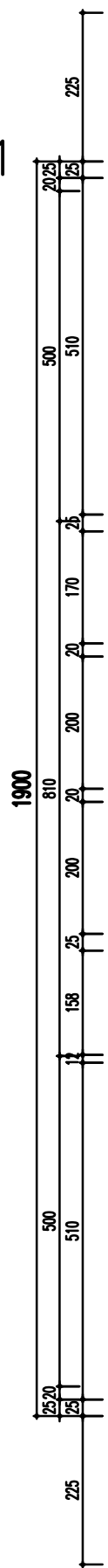

C.1

D.1

F

F

G

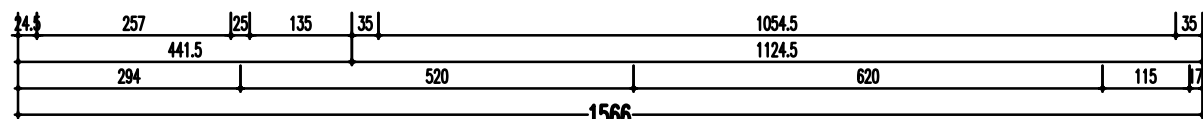
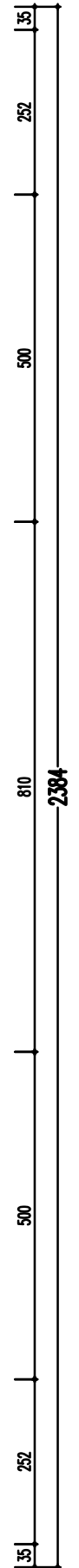

12a

13

14

1566

## LEGENDE:

- Bodentank
- Brandmelder selbsttätig
- Dimmer
- Schalter
- Klimagerät
- Mehrfachsteckdose
- Einfachsteckdose
- Datensteckdose

## 2. OBERGESCHOSS

Bauvorhaben:  
City Tower Linz  
Lastenstr. 36 4020 LINZ  
Bestandsplan M 1:100 2. OG  
Stand: 14.02.2013

Planverfasser:  
Dipl. Ing. Rene Kops  
Architekt – Ziviltechniker  
Reisnerstr. 32/16  
1030 WIEN